

AGS-SP-200-H

DESCRIPTION

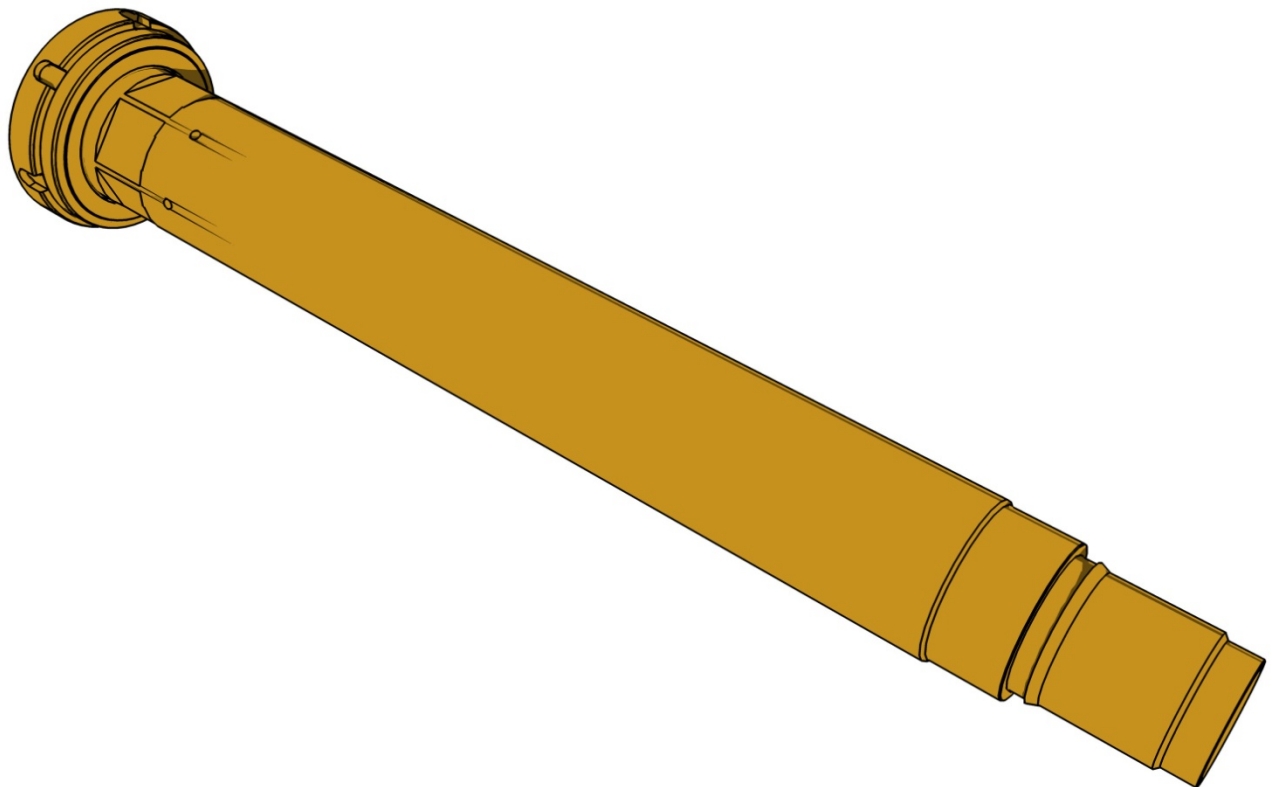

dametric 

HOLDER PART OF THE AGS-200 SENSOR

CONTENT

1	GENERAL.....	2
2	SEALING	2
3	MOUNTING.....	2
4	OUTLINE DRAWING	3
5	METSO PART NO	3
6	CONTACTS	3

1 GENERAL

The holder part of the AGS will mechanically fit the AGS-house to the refiner stator plate. There are several types of holders for different lengths, threads and sealing. The AGS-SP-200-H will fit the AGS in a Metso Paper RGP-200 refiner.

The holder is included in a new AGS sensor but can also be bought as a spare part. The holder is replaced if the thread is destroyed, if the sealing surface is uneven or if the contact surface to the segment plate is damaged.

2 SEALING

This type of holder includes a Shamban sealing, SHAMBAN-43, and seals toward the segment holder. Please check that the sealing is without damages when the holder is mounted in the refiner.

3 MOUNTING

The holder is mounted direct to the AGS house (AGD-HM3) and the sensor tip must be mounted afterwards.

Unscrew the locking nut, mount the holder and then put the locking nut back on again. The locking nut shall not be tightened yet; this to assure that the holder can be rotated when mounting the AGS sensor to the refiner.

Tight the locking nut when the AGS sensor is tightened toward the refiner plates.

4 OUTLINE DRAWING

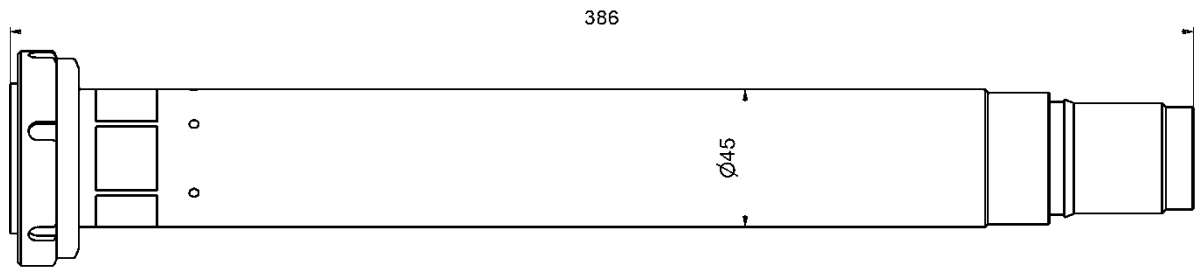

5 METSO PART NO

Metso part no.: VAL0243456.

6 CONTACTS

Development, production and service:

Dametric AB

Jägerhorns Väg 19, SE-141 75 Kungens Kurva, Sweden

Phone: +46-8 556 477 00 Telefax: +46-8 556 477 29

e-mail: service@dametric.se www.dametric.se

dametric 