

dametric 

# GIR-SW1



## GMS Industrial Router Switch

### Description

	Page
Table of contents	
<b>1 GENERAL</b> .....	<b>2</b>
<b>2 TECHNICAL DATA</b> .....	<b>2</b>
<b>3 DIMENSION</b> .....	<b>3</b>
<b>4 CONNECTIONS</b> .....	<b>4</b>
4.1 Power supply .....	4
4.2 Ethernet .....	4
<b>5 MOUNTING</b> .....	<b>4</b>
<b>6 VALMET ARTICLE NUMBER</b> .....	<b>4</b>
<b>7 CONTACT</b> .....	<b>4</b>

## 1 General

The GIR-SW1 unmanaged industrial fast ethernet switch is specifically designed to suit your heavy industrial environments. Switch provides 5-port 10/100Base-TX in a rugged, hardened case and components able to withstand a high degree of vibration and shock and an operating temperature. Not an ordinary industrial switch, the unit is engineered and designed especially for harsh and extreme industrial type applications. With its hardened case, redundant DC power inputs, and high performance components, the unit is perfectly suited for your extreme industrial automation environment.

The GIR-SW1 provides varied choice of deployment locations even in harsh environments with the Din-Rail option in a quick and easy way with no configuration required. The unit is equipped with auto MDI/MDI-X on all ports for simple connection to other switches and hubs. Each port has 2 LEDs to show the link status transmission speed which making troubleshooting the device a simple task.

## 2 Technical data

### Standards

IEEE 802.3	10Base-T
IEEE 802.3u	100Base-TX
IEEE 802.3x	Flow Control

### Performance

Throughput	14,880 pps to 10 Mbps ports 148,800 pps to 100 Mbps ports
Switch Fabric	1.6Gbps
MAC Table size	8K
Jumbo Frame Size	9K

### Power

Input Voltage	18~30V DC
Connection	Terminal block
Power Consumption	3W (Max)
Surge Protection	6KV
ESD Protection	8KV

### Interface

Ports	5 x 10/100Base-TX (RJ45)
-------	--------------------------

### Mechanical and environmental

Housing	Metal Case (IP30 protection)
DIN-Rail Mounting	Metal
Operating Temperature	0°C to 70°C

Operating Humidity	10 to 80% RH (non-condensing)
Storage Humidity	5 to 90% RH (non-condensing)
Weight	145g
Dimension	23.4x109.2x73.8mm (WxHxD)

**Standards and Certifications**

CE, EMI	FCC Part 15 Subpart B class A EN55022 EN 55011 EN 61000-6-4
CE, EMS	EN 55024 EN 61000-6-2 : IEC 61000-4-2 ( ESD ) : Level 3 IEC 61000-4-3 ( RS ) : Level 2 IEC 61000-4-4 ( Burst ) : Level 3 IEC 61000-4-5 ( Surge ) : Level 3 IEC 61000-4-6 ( CS ) : Level 3

**Approval and test**

Marine	DNV 2.4, IEC-60945, IACS E10 (Processing)
Shock	IEC 60068-2-27 (Processing)
Freefall	IEC 60068-2-32 (Processing)
Vibration	IEC 60068-2-6 (Processing)

**3 Dimension**

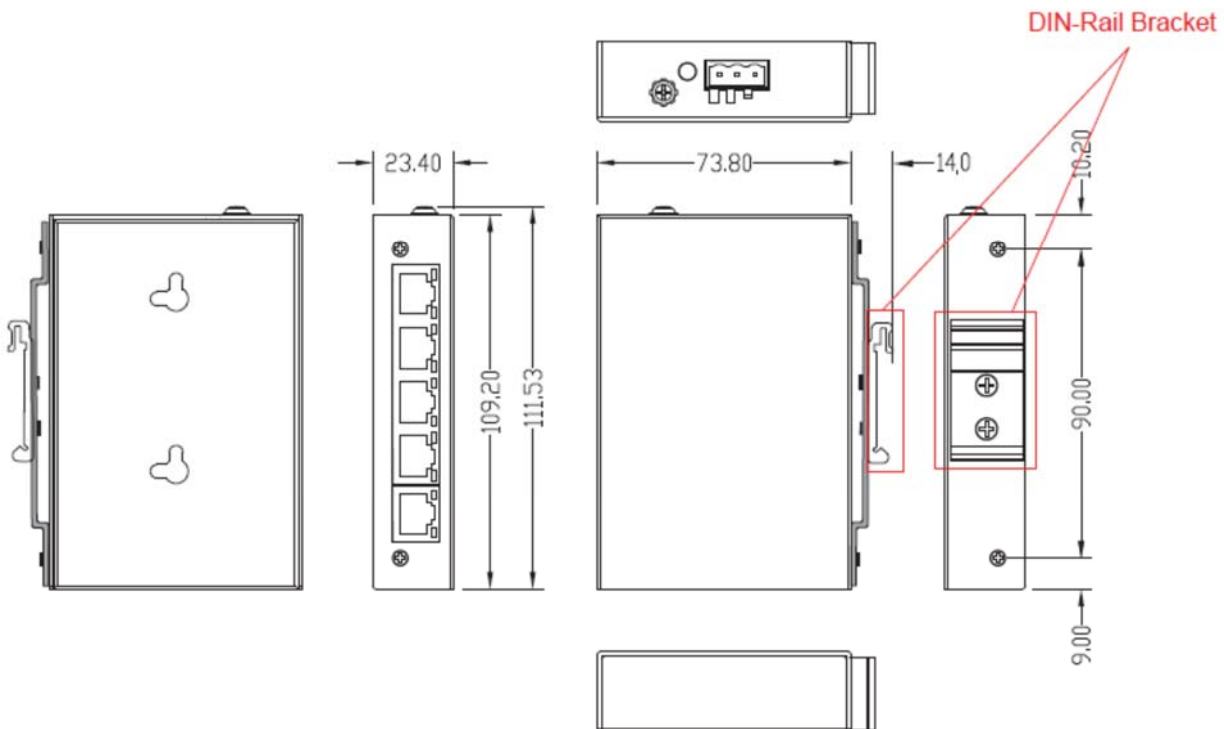

## 4 Connections

### 4.1 Power supply

Power supply

Connect the 0V to the connector marked “-“.

Connect the +24 V DC to the “+” connector.

Connect the ground bar to the grounding screw.

### 4.2 Ethernet

Connect the used Ethernet cables.

Suggested order:

Port	Item
1	Panel-PC
2	Router
3	CEC
4	Not used
5	Not used.

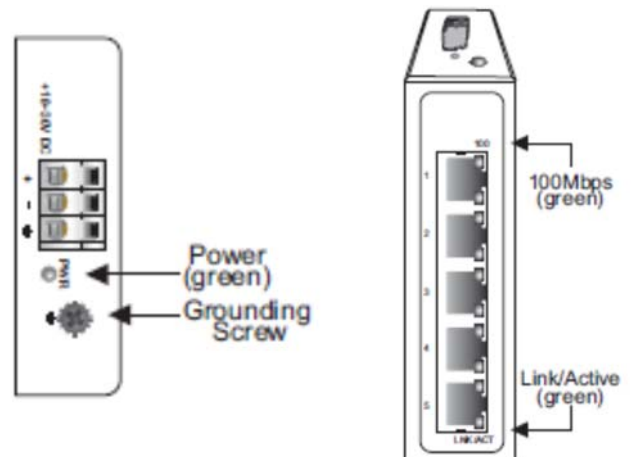

## 5 Mounting

See picture for mounting and removing the unit from the DIN rail.

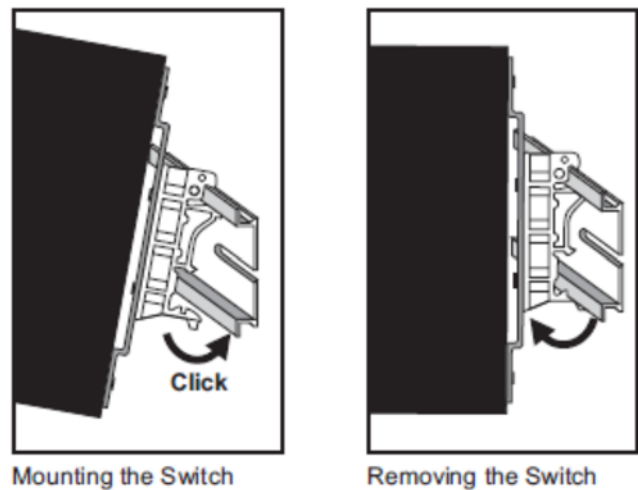

## 6 Valmet article number

VAL0366873.

## 7 Contact

Development, production and service:

### Dametric AB

Jägerhorns Väg 19, SE-141 75 Kungens Kurva, Sweden

Phone: +46-8 556 477 00

Telefax: +46-8 556 477 29

e-mail: [service@dametric.se](mailto:service@dametric.se)

[www.dametric.se](http://www.dametric.se)

dametric 