

dametric 

AGS-SB170

DESCRIPTION

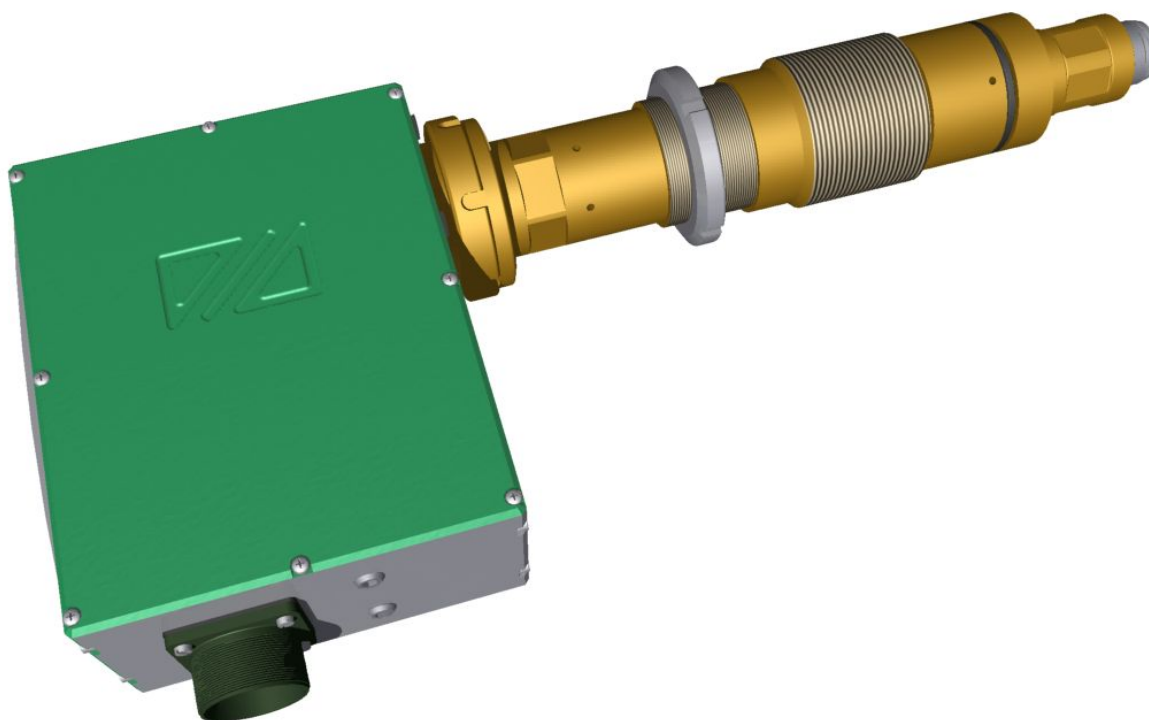

ADJUSTABLE GAP SENSOR

FOR ANDRITZ REFINERS
RTS SB-170 AND TWIN-66

CONTENT

1	GENERAL	2
2	SPECIFICATIONS	3
3	SPARE PART LIST	3
4	SENSOR TIP MOUNTING	3
5	ELECTRICAL CONNECTIONS	3
6	COOLING AIR CONNECTION	3
7	WEAR LIMIT INDICATOR	3
8	MOUNTING	4
9	OUTLINE DRAWING	5
10	CONTACTS	5

1 GENERAL

The AGS (Adjustable Gap Sensor) is a distance measurement device designed to measure the disc gap in a pulp refiner. The measuring tip can be moved axially, which enables a complete automatic calibration during full production in the refiner.

AGS-SB170 will fit the Andritz SB-170 and the TWIN-66 refiners and is based on three main parts; a house, a holder and a sensor tip.

The house includes a mechanical adjustment device, an electrical stepping motor, an axial position sensor and a sensor for the touch point vibration.

The holder is a mechanical adaptor between the house and measuring tip to the mechanical dimensions of the TDC-hole in the refiner stator plate. The AGS sensor has the same mechanical dimensions in the tip end as the corresponding TDC-sensor so they are interchangeable.

The tip is a wear part and will wear as the segment plates are worn down. The tip is replaced periodically by the mill service personnel.

2 SPECIFICATIONS

Dimensions:	See outline drawing
Weight:	7.0 kg
House material:	Painted aluminium / Stainless steel
Holder material:	Stainless steel / Bronze
Sensor tip material:	Stainless steel
House temperature range:	0 – 65 °C
Tip temperature range:	0 – 225 °C
Wear range:	3 mm (see item WEAR LIMIT INDICATOR)
Connector:	19 pole MIL-C-5015 with aluminium case
Tip adjustment range:	± 2.50 mm.
Metso article no.:	VAL0253898

3 SPARE PART LIST

House:	AGD-HM3	VAL0196738
Holder:	AGS-SP-SB170-H	VAL0255774
Sensor tip:	AGS-XP-250	VAL0253809

The sensor installation also needs a sleeve for the refiner housing, AGS-SP-SB170-FO. This part is not included in the AGS sensor assembly and must be bought separately.

4 SENSOR TIP MOUNTING

Check the description of the sensor tip, AGS-XP-250 on how it is changed.

Adjust the AGS holder part until the tip surface is flush with the segment plate surface.

5 ELECTRICAL CONNECTIONS

The AGS sensor is electrically connected to a connection box, KB-AGS1, mounted on the refiner stand.

6 COOLING AIR CONNECTION

The high ambient temperature due to the warm steel plates around the AGS sensor will shorten the life time if the AGS house is not cooled. We strongly recommend that cool instrument air is continuously attached to the sensor. Use clear, dry and oil free instrument air, connected to the 6mm hose nipple. The air flow should be app. 10 litres/min (0.25 gallons/min).

7 WEAR LIMIT INDICATOR

It is important that the sensor is not worn beyond the indicator marked in drawing below. Note that this is after the estimated plate life. A sensor worn beyond this point may result in a plate crash and furthermore affect the refiner security.

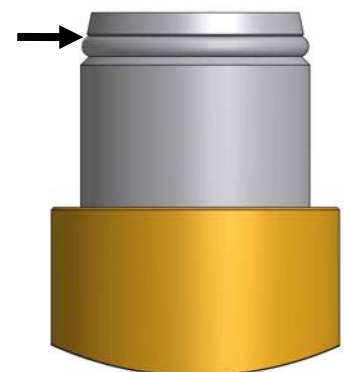

8 MOUNTING

1. Check and grease the o-ring (A) on the holder (B). Thread the holder into flange (H) as far as it can go.
2. Mount the AGS-huset (C) and tighten with the nut (D).
3. Mount the measuring tip (E), check the measuring tip manual.
4. Mount the segment plate (F).
5. Adjust the AGS sensor by rotating the holder (B) until the tip surface is flush with the segment plate surface. The accuracy of the adjustment should be better than 0.10mm.
6. Lock the holder with the nut (G).
7. Use the Panel-PC and the "Adjust Flush pos." function to adjust the tip until completely flush with the stator plate (< 0.01mm error).

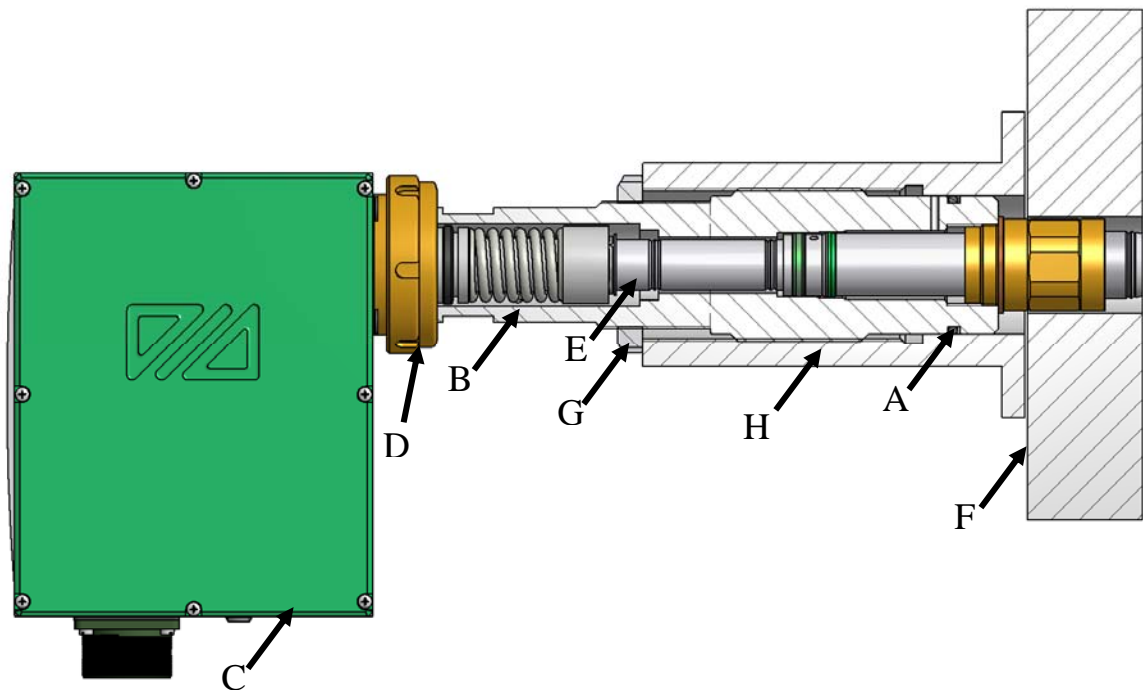

9 OUTLINE DRAWING

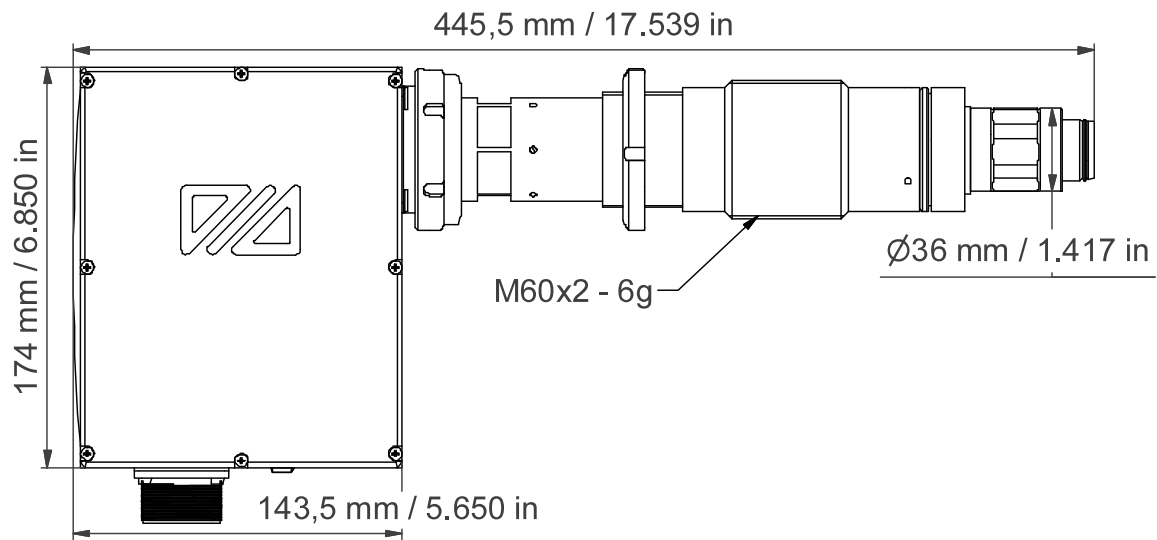

10 CONTACTS

Sales, development, production and service:

Dametric AB

Jägerhorns Väg 19, SE-141 75 Kungens Kurva, Sweden

Phone: +46-8 556 477 00 Telefax: +46-8 556 477 29

e-mail: info@dametric.se www.dametric.se

dametric 