

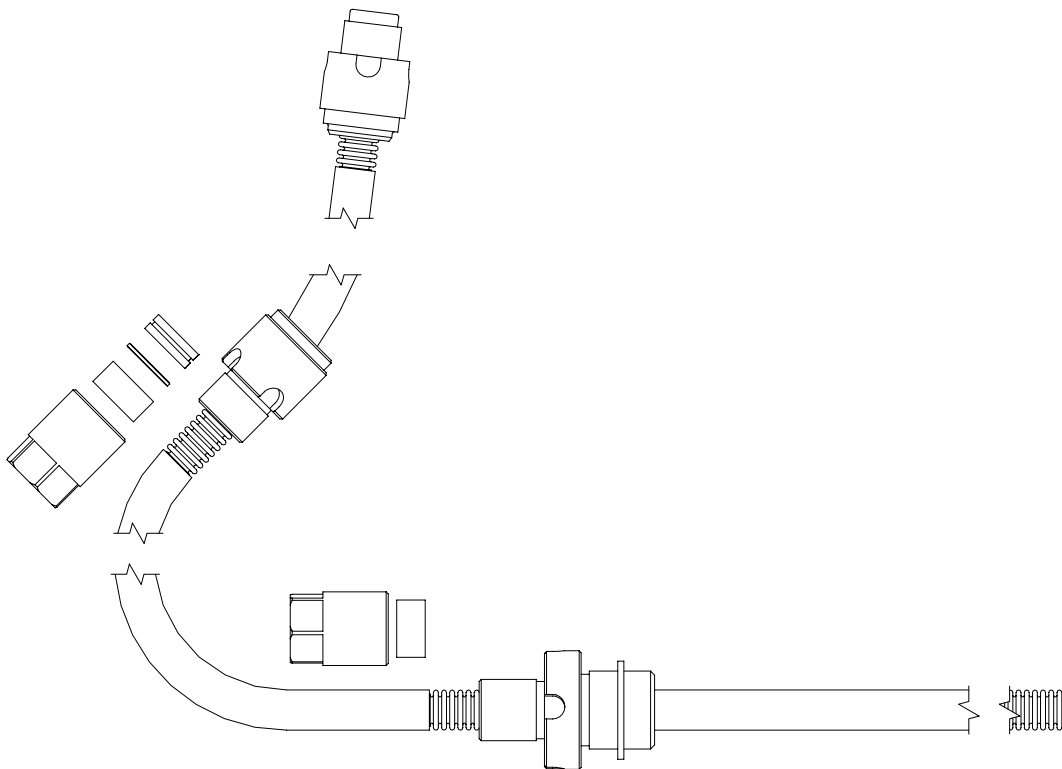

K-RZD4

VAL0180558



TDC SENSOR CABLE PART FOR RGP42DD
ROTOR AND SHAFT CABLE PROTECTION TUBE

DESCRIPTION



CONTENTS

1. GENERAL
2. PARTS
3. MOUNTING INSTRUCTION
4. ASSEMBLY DRAWING

1. GENERAL

The K-RZD4 is a set of parts and will serve as protection and sealing for an electrical cable, K-RZD3. It is mounted inside the rotor and shaft of a RGP-42CD/DD refiner, and consists of a flexible metal tube, sleeves and washers. The parts are mounted, locked and sealed at three locations in the rotor and shaft and will then enable that the K-RZD3 cable can be mounted easily.

2. PARTS

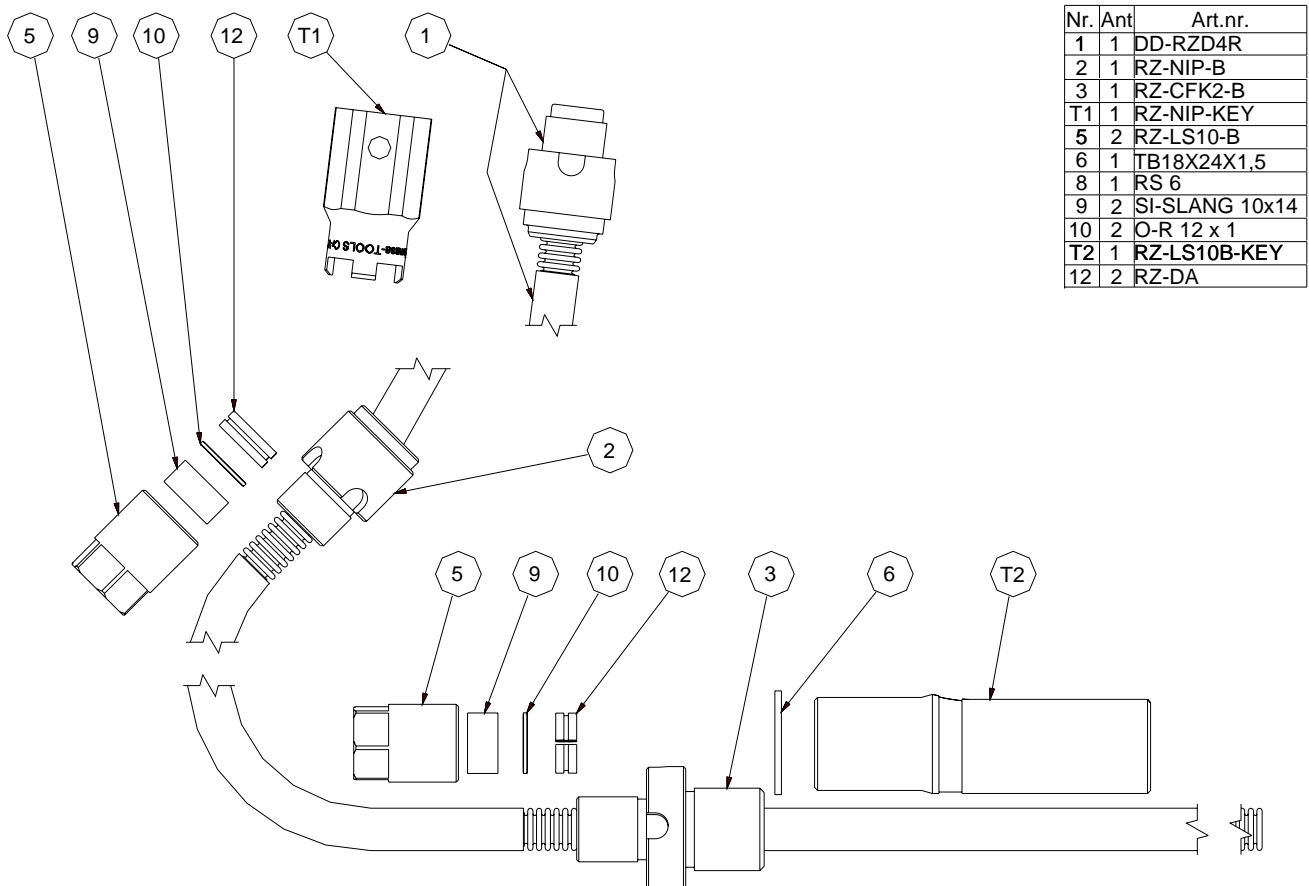

3. MOUNTING INSTRUCTION

Please read this instruction completely before you start the mounting procedure.

- Clean and check that all three treads are in good condition.
- Mount the fittings RZ-NIP-B at (pos B), TB18x25x1,5 and RZ-CFK2-B (pos C) with the tool RZ-NIP-KEY.
- Slide the metal hose DD-RZD4R into the segment holder from pos A to pos B tighten the thread.
- Mount the RZ-DA as close as possible to the RZ-NIP-B (at pos B) and then slip O-R 12x1, SI-SLANG 12x14 and RZ-LS10-B on to the metal hose, tighten the sleeve RZ-LS10-B.
- Slip another O-R 12x1, SI-SLANG 12x14 and RZ-LS10-B on to the metal hose.
- Push the metal hose into the centre of the shaft.
- Tighten the threaded sleeve RZ-LS10-B.
- Cut the metal hose to appropriate length and make sure to remove all sharp edges at the end of the metal hose.

4.1 ASSEMBLY DRAWING, CABLE

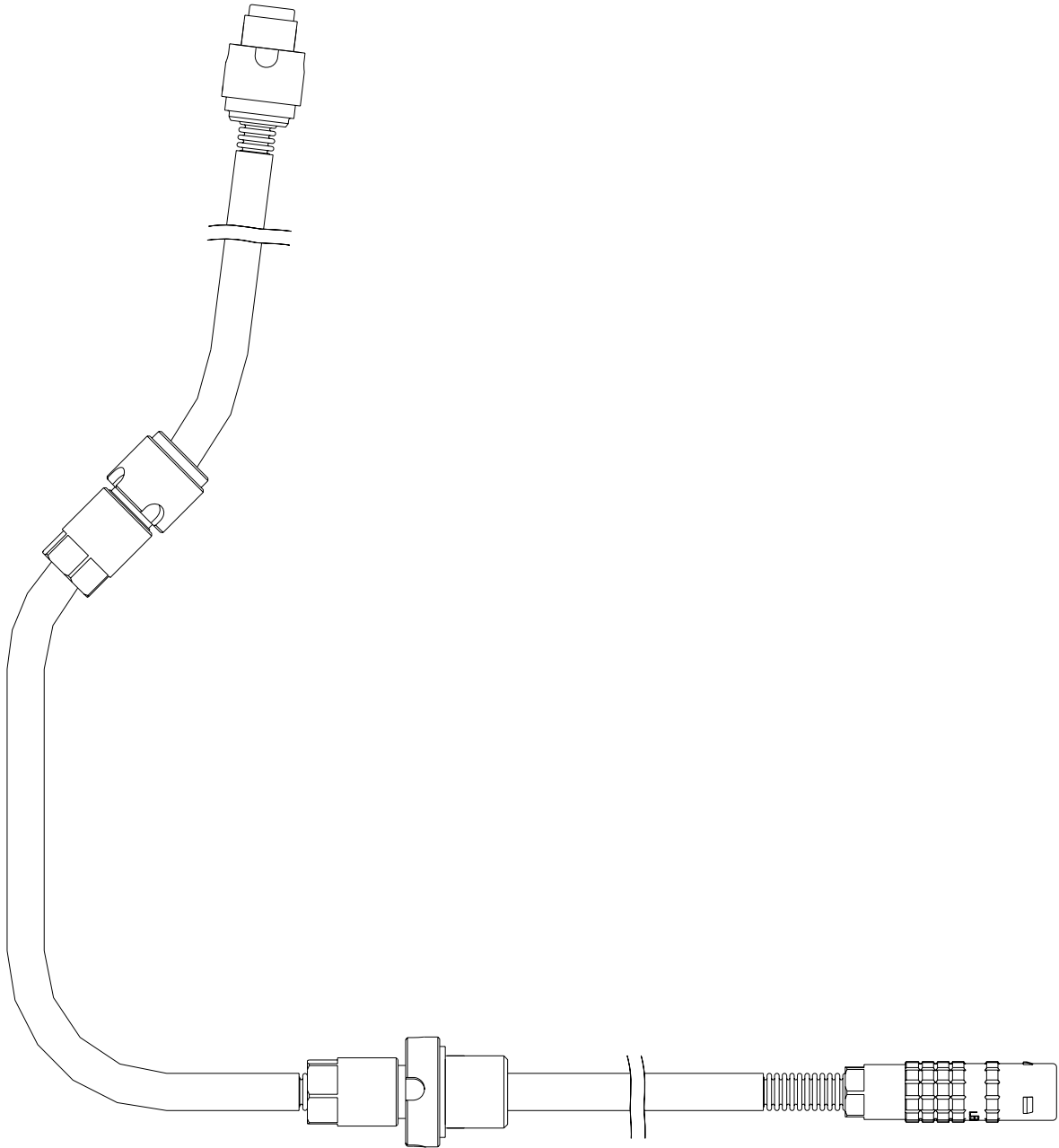

4. ASSEMBLY DRAWING, ROTOR

